

No 241

TOWNSHIP N^o: 19 NORTH RANGE N^o: VII EAST OF 6th PRINCIPAL MERIDIAN NEB. TER.

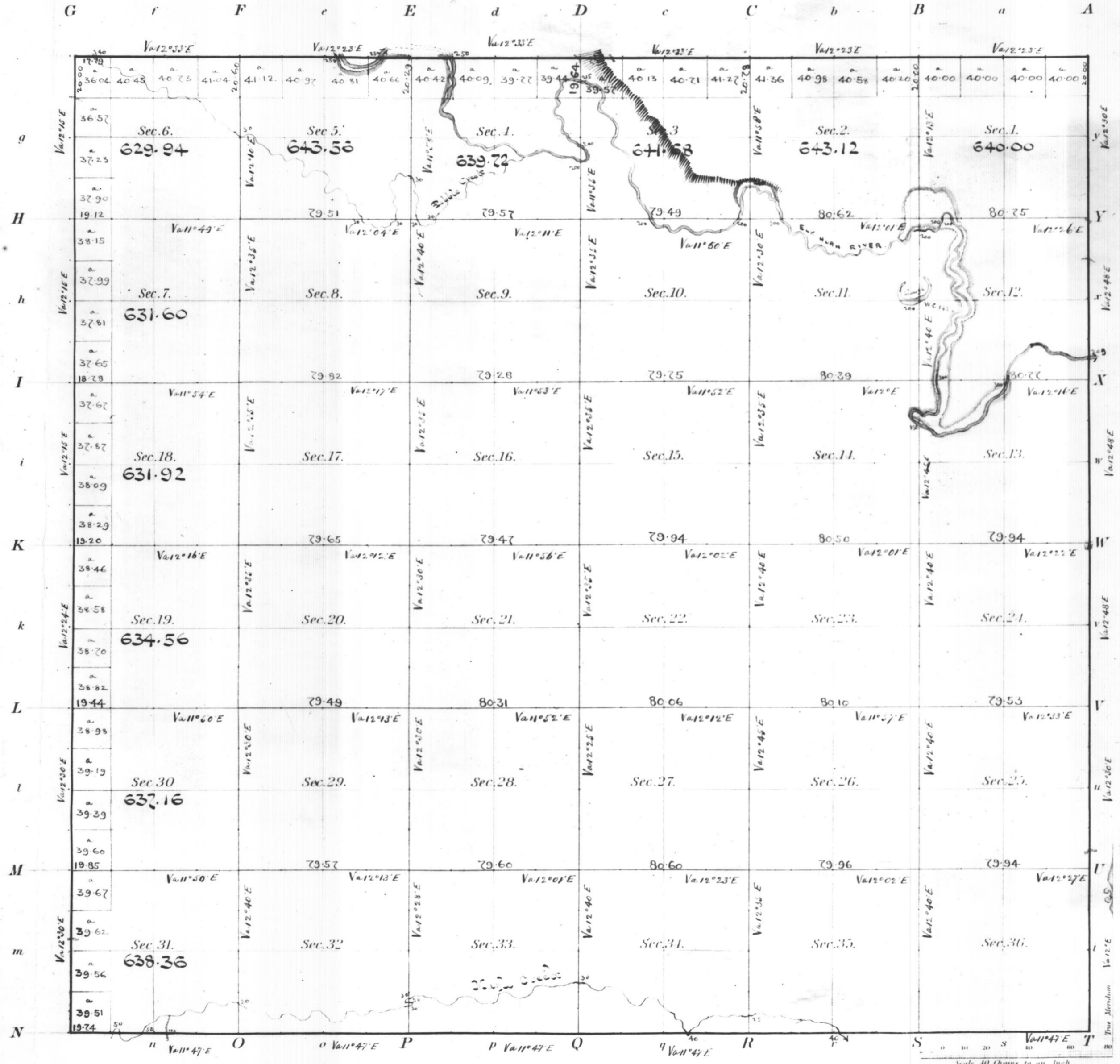

Total number of Acres, 23 011.62

Meanders of

Posts	Courses	Ch. Lk.	Posts	Courses	Ch. Lk.	Posts	Courses	Ch. Lk.

Surveys Designated	By Whom Surveyed	Date of Contract	Amount of Surveys	When Surveyed
Township lines	Alexander Clephat	June 9 th 1857	M. Ch. Lk.	Aug 8 th 1857
Subdivisions	Andrus T. Perrie	Mar 27 th 1857	59.76.31	Apr 2 nd 1857

The above Map of Township 19 North of Range 7 East of the 6th Principal Meridian Nebraska Territory is strictly conformable to the field notes of the survey thereof on file in this office, which have been examined and approved.

Surveyor General's Office,
 S. C. Johnson
 S. C. Johnson
 Dec 5. 1857