

No. 154

# TOWNSHIP N° 18 NORTH RANGE N° V EAST OF THE 6<sup>TH</sup> PRINCIPAL MERIDIAN.

[NEB. TER.]

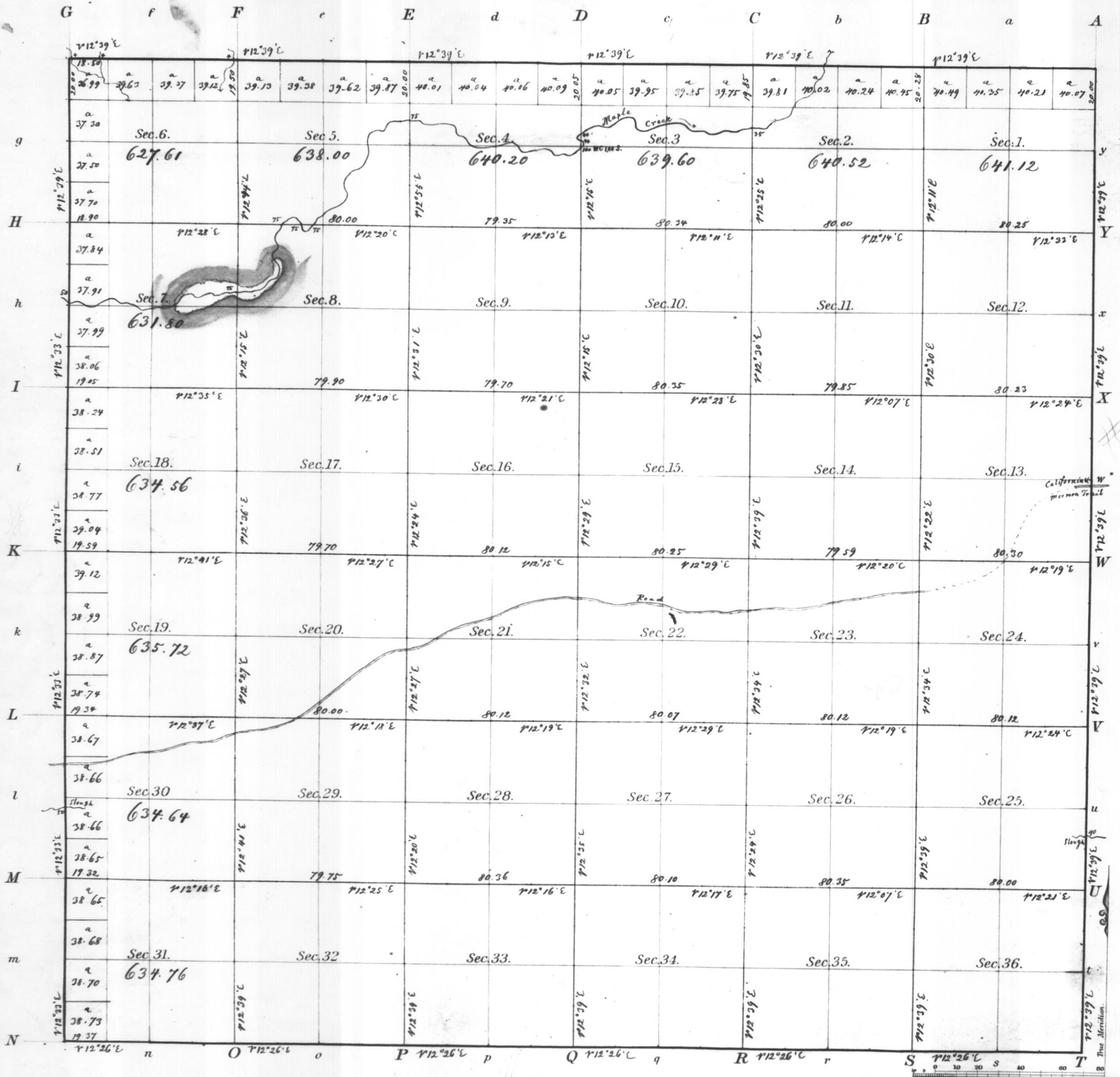

| Meanders of |         |         |       |         |         |       |         |         |
|-------------|---------|---------|-------|---------|---------|-------|---------|---------|
| Posts       | Courses | Ch. Lk. | Posts | Courses | Ch. Lk. | Posts | Courses | Ch. Lk. |
|             |         |         |       |         |         |       |         |         |
|             |         |         |       |         |         |       |         |         |
|             |         |         |       |         |         |       |         |         |
|             |         |         |       |         |         |       |         |         |
|             |         |         |       |         |         |       |         |         |
|             |         |         |       |         |         |       |         |         |
|             |         |         |       |         |         |       |         |         |
|             |         |         |       |         |         |       |         |         |
|             |         |         |       |         |         |       |         |         |
|             |         |         |       |         |         |       |         |         |
|             |         |         |       |         |         |       |         |         |
|             |         |         |       |         |         |       |         |         |
|             |         |         |       |         |         |       |         |         |
|             |         |         |       |         |         |       |         |         |
|             |         |         |       |         |         |       |         |         |
|             |         |         |       |         |         |       |         |         |
|             |         |         |       |         |         |       |         |         |
|             |         |         |       |         |         |       |         |         |
|             |         |         |       |         |         |       |         |         |
|             |         |         |       |         |         |       |         |         |
|             |         |         |       |         |         |       |         |         |

Total number of Acres. 22998.53

| Surveys Designated | By Whom Surveyed  | Date of Contract           | Amount of Surveys | When Surveyed                                   |
|--------------------|-------------------|----------------------------|-------------------|---|
| Township lines     | Alexander Clapham | June 9 <sup>th</sup> 1857  | M. Ch. Lk.        | August 1857                                     |
| Subdivisions       | Charles J. Peck   | June 11 <sup>th</sup> 1857 | 59 76.80          | August 10 <sup>th</sup> & 11 <sup>th</sup> 1857 |

The above Map of Township N° 18 North of Range N° V East of the 6<sup>th</sup> Principal Meridian Nebraska Territory is strictly conformable to the field notes of the survey thereof on file in this Office, which have been examined and approved.

Surveyor General's Office,  
 Sacramento, T. 2, Oct. 3, 1857

J. C. [Signature]  
 Sur. Gen!